



Havering
LONDON BOROUGH

Copy of Application



**Winckworth
Sherwood**

By Special Delivery

Licensing Section
Public Protection
London Borough of Havering
c/o Town Hall
Main Road
Romford
RM1 3BD

Solicitors and
Parliamentary Agents

Minerva House
5 Montague Close
London
SE1 9BB
DX: 156810 London Bridge 6
Switchboard 020 7593 5000
Direct Line 020 7593 0277
www.wslaw.co.uk

Our Ref: CVE/28715/67/RPB

6 October 2014

Dear Sirs

Application to vary Premises Licence

Applicant: Malthurst Limited
Premises: Malthurst Faringdon, Faringdon Avenue, Romford, RM3 0AB
Premises Licence No: 11658

1. Application to vary the premises licence pursuant to Section 34 of the Licensing Act 2003.
2. A layout plan in the specified form to which the application relates (dated August 2014).
3. The premises licence.
4. A cheque for £190 in respect of your fee.

We are authorised to sign the application on behalf of Malthurst Limited.

We confirm that a copy of this application has been sent to each of the responsible authorities.

Please ensure that all correspondence relating to this application is sent to this office and not to the applicant or the premises.

Yours faithfully

Winckworth Sherwood LLP

DT 020 7593 0277
DF 020 7593 5099
cedwards@wslaw.co.uk

021014122205.DOCX

Registered in England and Wales OC334359. Winckworth Sherwood LLP is authorised and regulated by the Solicitors Regulation Authority. A list of partners is available for inspection at the above address. The term Partner is used to refer to a Member of Winckworth Sherwood LLP.

Lexcel
Practice Management Standard
Law Society Accredited



Application to vary a premises licence under the Licensing Act 2003

PLEASE READ THE FOLLOWING INSTRUCTIONS FIRST

Before completing this form please read the guidance notes at the end of the form. If you are completing this form by hand please write legibly in block capitals. In all cases ensure that your answers are inside the boxes and written in black ink. Use additional sheets if necessary.

You may wish to keep a copy of the completed form for your records.

I/We Malthurst Limited

(Insert name(s) of applicant)

being the premises licence holder, apply to vary a premises licence under section 34 of the Licensing Act 2003 for the premises described in Part 1 below

Premises licence number 11658

Part 1 – Premises Details

Postal address of premises or, if none, ordnance survey map reference or description Malthurst Faringdon Faringdon Avenue			
Post town	Romford	Postcode	RM3 0AB

Telephone number at premises (if any)	
Non-domestic rateable value of premises	£23,000

Part 2 – Applicant details

Daytime contact telephone number	01992 571937		
E-mail address (optional)			
Current postal address if different from premises address	Vincent House 4 Grove Lane All correspondence to: Winckworth Sherwood LLP (Ref: CVE/28715/67/RPB) Minerva House 5 Montague Close London SE1 9BB		
Post town	Epping	Postcode	CM16 4LH

Part 3 - Variation

Please tick as appropriate

Do you want the proposed variation to have effect as soon as possible?

Yes

No

If not, from what date do you want the variation to take effect?

DD	MM	YYYY
┆	┆	┆
┆	┆	┆
┆	┆	┆
┆	┆	┆

Please describe briefly the nature of the proposed variation (Please see guidance note 1)

A petrol forecourt store selling a broad range of groceries, household products and alcohol. Situated at Malthurst Faringdon, Faringdon Avenue, Romford, RM3 0AB to be varied as follows:

1. To include the provision of late night refreshment between the hours of 2300 and 0500 daily.
2. To extend and make alteration to the premises.

If your proposed variation would mean that 5,000 or more people are expected to attend the premises at any one time, please state the number expected to attend:

Part 4 Operating Schedule

Please complete those parts of the Operating Schedule below which would be subject to change if this application to vary is successful.

Provision of regulated entertainment

Please tick all that apply

- a) plays (if ticking yes, fill in box A)
- b) films (if ticking yes, fill in box B)
- c) indoor sporting events (if ticking yes, fill in box C)
- d) boxing or wrestling entertainment (if ticking yes, fill in box D)
- e) live music (if ticking yes, fill in box E)
- f) recorded music (if ticking yes, fill in box F)
- g) performances of dance (if ticking yes, fill in box G)
- h) anything of a similar description to that falling within (e), (f) or (g)
(if ticking yes, fill in box H)

Provision of late night refreshment (if ticking yes, fill in box I)

Sale by retail of alcohol (if ticking yes, fill in box J)

In all cases complete boxes K, L and M

A

Plays Standard days and timings (please read guidance note 6)			<u>Will the performance of a play take place indoors or outdoors or both – please tick</u> (please read guidance note 2)	Indoors	<input type="checkbox"/>
				Outdoors	<input type="checkbox"/>
				Both	<input type="checkbox"/>
Day	Start	Finish	<u>Please give further details here</u> (please read guidance note 3)		
Mon					
Tue			<u>State any seasonal variations for performing plays</u> (please read guidance note 4)		
Wed					
Thur			<u>Non standard timings. Where you intend to use the premises for the performance of plays at different times to those listed in the column on the left, please list</u> (please read guidance note 5)		
Fri					
Sat					
Sun					

B

Films Standard days and timings (please read guidance note 6)			<u>Will the exhibition of films take place indoors or outdoors or both – please tick</u> (please read guidance note 2)	Indoors	<input type="checkbox"/>
				Outdoors	<input type="checkbox"/>
				Both	<input type="checkbox"/>
Day	Start	Finish	<u>Please give further details here</u> (please read guidance note 3)		
Mon					
Tue					
Wed					
			<u>State any seasonal variations for the exhibition of films</u> (please read guidance note 4)		
Thur					
			<u>Non standard timings. Where you intend to use the premises for the exhibition of films at different times to those listed in the column on the left, please list</u> (please read guidance note 5)		
Fri					
Sat					
Sun					

C

Indoor sporting events Standard days and timings (please read guidance note 6)			Please give further details (please read guidance note 3)
Day	Start	Finish	
Mon			
Tue			State any seasonal variations for indoor sporting events (please read guidance note 4)
Wed			
Thur			Non standard timings. Where you intend to use the premises for indoor sporting events at different times to those listed in the column on the left, please list (please read guidance note 5)
Fri			
Sat			
Sun			

D

Boxing or wrestling entertainments Standard days and timings (please read guidance note 6)			<u>Will the boxing or wrestling entertainment take place indoors or outdoors or both – please tick</u> (please read guidance note 2)	Indoors	<input type="checkbox"/>
				Outdoors	<input type="checkbox"/>
				Both	<input type="checkbox"/>
Day	Start	Finish			
Mon			<u>Please give further details here</u> (please read guidance note 3)		
Tue					
Wed			<u>State any seasonal variations for boxing or wrestling entertainment</u> (please read guidance note 4)		
Thur					
Fri			<u>Non standard timings. Where you intend to use the premises for boxing or wrestling entertainment at different times to those listed in the column on the left, please list</u> (please read guidance note 5)		
Sat					
Sun					

E

Live music Standard days and timings (please read guidance note 6)			<u>Will the performance of live music take place indoors or outdoors or both – please tick (please read guidance note 2)</u>	Indoors	<input type="checkbox"/>
				Outdoors	<input type="checkbox"/>
				Both	<input type="checkbox"/>
Day	Start	Finish	<u>Please give further details here (please read guidance note 3)</u>		
Mon					
Tue			<u>State any seasonal variations for the performance of live music (please read guidance note 4)</u>		
Wed					
Thur			<u>Non standard timings. Where you intend to use the premises for the performance of live music at different times to those listed in the column on the left, please list (please read guidance note 5)</u>		
Fri					
Sat					
Sun					

F

Recorded music Standard days and timings (please read guidance note 6)			<u>Will the playing of recorded music take place indoors or outdoors or both – please tick (please read guidance note 2)</u>	Indoors	<input type="checkbox"/>
				Outdoors	<input type="checkbox"/>
				Both	<input type="checkbox"/>
Day	Start	Finish	<u>Please give further details here (please read guidance note 3)</u>		
Mon					
Tue			<u>State any seasonal variations for the playing of recorded music (please read guidance note 4)</u>		
Wed					
Thur			<u>Non standard timings. Where you intend to use the premises for the playing of recorded music at different times to those listed in the column on the left, please list (please read guidance note 5)</u>		
Fri					
Sat					
Sun					

G

Performances of dance Standard days and timings (please read guidance note 6)			<u>Will the performance of dance take place indoors or outdoors or both – please tick</u> (please read guidance note 2)	Indoors	<input type="checkbox"/>			
				Outdoors	<input type="checkbox"/>			
				Both	<input type="checkbox"/>			
Day	Start	Finish	<u>Please give further details here</u> (please read guidance note 3)					
Mon								
Tue								
Wed						<u>State any seasonal variations for the performance of dance</u> (please read guidance note 4)		
Thur								
Fri						<u>Non standard timings. Where you intend to use the premises for the performance of dance at different times to those listed in the column on the left, please list</u> (please read guidance note 5)		
Sat								
Sun								

H

Anything of a similar description to that falling within (e), (f) or (g) Standard days and timings (please read guidance note 6)			Please give a description of the type of entertainment you will be providing		
Day	Start	Finish	<u>Will this entertainment take place indoors or outdoors or both – please tick</u> (please read guidance note 2)	Indoors	<input type="checkbox"/>
Mon				Outdoors	<input type="checkbox"/>
				Both	<input type="checkbox"/>
Tue			<u>Please give further details here</u> (please read guidance note 3)		
Wed					
Thur			<u>State any seasonal variations for entertainment of a similar description to that falling within (e), (f) or (g)</u> (please read guidance note 4)		
Fri					
Sat			<u>Non standard timings. Where you intend to use the premises for the entertainment of a similar description to that falling within (e), (f) or (g) at different times to those listed in the column on the left, please list</u> (please read guidance note 5)		
Sun					

I

Late night refreshment Standard days and timings (please read guidance note 6)			<u>Will the provision of late night refreshment take place indoors or outdoors or both – please tick</u> (please read guidance note 2)	Indoors	<input type="checkbox"/>			
				Outdoors	<input type="checkbox"/>			
				Both	<input checked="" type="checkbox"/>			
Day	Start	Finish	<u>Please give further details here</u> (please read guidance note 3)					
Mon	0000	0500						
	2300	2400						
Tue	0000	0500						
	2300	2400						
Wed	0000	0500				<u>State any seasonal variations for the provision of late night refreshment</u> (please read guidance note 4)		
	2300	2400						
Thur	0000	0500						
	2300	2400						
Fri	0000	0500	<u>Non standard timings. Where you intend to use the premises for the provision of late night refreshment at different times, to those listed in the column on the left, please list</u> (please read guidance note 5)					
	2300	2400						
Sat	0000	0500						
	2300	2400						
Sun	0000	0500						
	2300	2400						

J

Supply of alcohol Standard days and timings (please read guidance note 6)			Will the supply of alcohol be for consumption – please tick (please read guidance note 7)	On the premises	<input type="checkbox"/>
				Off the premises	<input type="checkbox"/>
				Both	<input type="checkbox"/>
Day	Start	Finish	State any seasonal variations for the supply of alcohol (please read guidance note 4)		
Mon					
Tue					
Wed					
Thur					
Fri					
Sat					
Sun					
			Non-standard timings. Where you intend to use the premises for the supply of alcohol at different times to those listed in the column on the left, please list (please read guidance note 5)		

K

Please highlight any adult entertainment or services, activities, other entertainment or matters ancillary to the use of the premises that may give rise to concern in respect of children (please read guidance note 8).

The premises sell alcohol and other age restricted products.

L

Hours premises are open to the public Standard days and timings (please read guidance note 6)			State any seasonal variations (please read guidance note 4)
Day	Start	Finish	
Mon	0000	2400	
Tue	0000	2400	
Wed	0000	2400	
Thur	0000	2400	
Fri	0000	2400	
Sat	0000	2400	
Sun	0000	2400	
			Non standard timings. Where you intend the premises to be open to the public at different times from those listed in the column on the left, please list (please read guidance note 5) The applicant may elect not to open the store, or part(s) of the store, 24 hours every day but requires the flexibility to do so subject to statutory or operational restrictions.

Please identify those conditions currently imposed on the licence which you believe could be removed as a consequence of the proposed variation you are seeking.

None

Please tick as appropriate

- I have enclosed the premises licence
- I have enclosed the relevant part of the premises licence

If you have not ticked one of these boxes, please fill in reasons for not including the licence or part of it below

Reasons why I have not enclosed the premises licence or relevant part of premises licence.

M

Describe any additional steps you intend to take to promote the four licensing objectives as a result of the proposed variation:

a) General – all four licensing objectives (b, c, d and e) (please read guidance note 9)

There are no proposed changes to the existing conditions on the premises licence.

b) The prevention of crime and disorder

c) Public safety

d) The prevention of public nuisance

e) The protection of children from harm

Checklist:

Please tick to indicate agreement

- I have made or enclosed payment of the fee.
- I have sent copies of this application and the plan to responsible authorities and others where applicable.
- I understand that I must now advertise my application.
- I have enclosed the premises licence or relevant part of it or explanation.
- I understand that if I do not comply with the above requirements my application will be rejected.

IT IS AN OFFENCE, LIABLE ON SUMMARY CONVICTION TO A FINE NOT EXCEEDING LEVEL 5 ON THE STANDARD SCALE, UNDER SECTION 158 OF THE LICENSING ACT 2003, TO MAKE A FALSE STATEMENT IN OR IN CONNECTION WITH THIS APPLICATION.

Part 5 – Signatures (please read guidance note 10)

Signature of applicant (the current premises licence holder) or applicant’s solicitor or other duly authorised agent (please read guidance note 11). **If signing on behalf of the applicant, please state in what capacity.**

Signature	W8henwood WP
Date	6 October 2014
Capacity	Solicitors duly authorised on behalf of the Applicant

Where the premises licence is jointly held, signature of 2nd applicant (the current premises licence holder) or 2nd applicant’s solicitor or other authorised agent (please read guidance note 12). **If signing on behalf of the applicant, please state in what capacity.**

Signature	
Date	
Capacity	

Contact name (where not previously given) and address for correspondence associated with this application (please read guidance note 13)

(Ref: CVE/28715/67/RPB)
 Winckworth Sherwood LLP
 Minerva House
 5 Montague Close

Post town	London	Post code	SE1 9BB
Telephone number (if any)	020 7593 0277		
If you would prefer us to correspond with you by e-mail, your e-mail address (optional) cedwards@wslaw.co.uk			

Notes for Guidance

This application cannot be used to vary the licence so as to extend the period for which the licence has effect or to vary substantially the premises to which it relates. If you wish to make that type of change to the premises licence, you should make a new premises licence application under section 17 of the Licensing Act 2003.

1. Describe the premises. For example the type of premises, its general situation and layout and any other information which could be relevant to the licensing objectives. Where your application includes off-supplies of alcohol and you intend to provide a place for consumption of these off-supplies, you must include a description of where the place will be and its proximity to the premises.
2. Where taking place in a building or other structure please tick as appropriate (indoors may include a tent).
3. For example state type of activity to be authorised, if not already stated, and give relevant further details, for example (but not exclusively) whether or not music will be amplified or unamplified.
4. For example (but not exclusively), where the activity will occur on additional days during the summer months.
5. For example (but not exclusively), where you wish the activity to go on longer on a particular day e.g. Christmas Eve.
6. Please give timings in 24 hour clock (e.g. 16:00) and only give details for the days of the week when you intend the premises to be used for the activity.
7. If you wish people to be able to consume alcohol on the premises, please tick 'on the premises'. If you wish people to be able to purchase alcohol to consume away from the premises, please tick 'off the premises'. If you wish people to be able to do both, please tick 'both'.
8. Please give information about anything intended to occur at the premises or ancillary to the use of the premises which may give rise to concern in respect of children regardless of whether you intend children to have access to the premises, for example (but not exclusively) nudity or semi-nudity, films for restricted age groups or the presence of gaming machines.
9. Please list here steps you will take to promote all four licensing objectives together.
10. The application form must be signed.
11. An applicant's agent (for example solicitor) may sign the form on their behalf provided that they have actual authority to do so.
12. Where there is more than one applicant, each of the applicants or their respective agents must sign the application form.
13. This is the address which we shall use to correspond with you about this application.

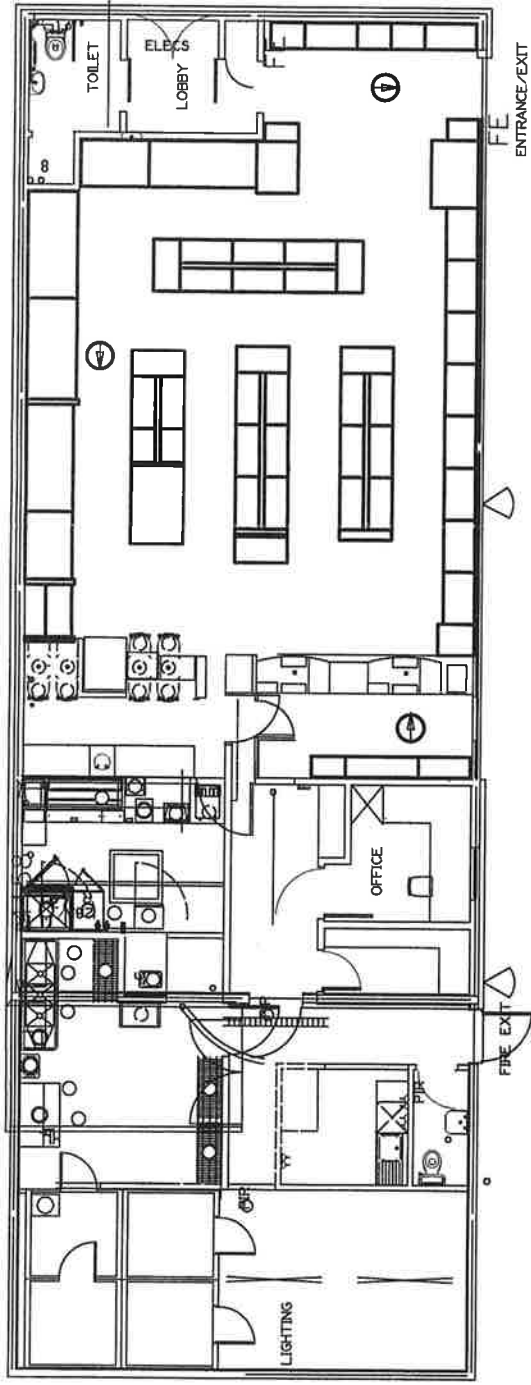

KEY:-

⊕ = CCTV CAMERA

FE = FIRE EXTINGUISHER

SHOP SIZE = 110 SQUARE METRES

THE ENTIRE PREMISES MAY BE USED FOR THE SALE OF ALCOHOL AND THE PROVISION OF LATE NIGHT REFRESHMENT

MRH SPAR FARINGDON WITH SUBWAY
 PREMISES LICENCE VARIATION DRAWING
 SCALE 1:100 ON A3 PAPER
 AUGUST 2014

Recorder

jobs24.co.uk

IN-PAPER • ONLINE • ON MOBILE



Recruitment 0845 671 4460

Property | Recruitment | Public Notices | Family Announcements | Articles for Sale | Expert Services | Motors | Personal

Do you want to get fit and earn money?

Distributors Wanted

To deliver a free newspaper in
RM2 5/RM11.1/RM11.3
RM12.4/RM12.6/RM14.2



Good rates of pay

You must be age 13+ and be available
on a Friday

For more information please call
01708 721561

Please leave name, address and tel. no
or email carole.taylor@whistl.co.uk

Experienced HGV Skip Driver
And
Experienced 360 Machine Operator
required by busy East London based company
Excellent rates of pay

I.O.D

SKIP HIRE LTD

Contact Steve:
020 7476 0227 or
07864 029 145

Accountancy

HORNCHURCH
Construction Company
requires
Accounts Manager
to maintain accounting
records for 3 companies.
Applicant must be AAT
qualified and have Sage,
Payroll, Excel and CIS
experience. You must be
self-motivated and flexible.
Salary negotiable.
Closing date for
applications:
17th October 2014.
Please send CV to
lindawright@bowmite.com

Building Trades

**STEEL FIXERS &
ARCHITECTURAL MET-
ALWORKERS MUST
HAVE CSCS CARDS**
CALL DAVE
07947
155859

Dental & Optical

**F/T DENTAL NURSE
FOR PRIVATE PRACTICE**
Hornchurch/Harold
Wood
GDC registered. Some
Computer/reception
experience
advantageous.
Excellent working envi-
ronment. Requirements:
An enthusiastic, flexible
& capable team player.
Good rates of pay.
Contact Sue
07946 683576

Care Staff

CARE home requires a
Care Assistant to
work on a rota system.
Experience of caring for
the elderly with dementia
is required. Health and
Social Care Level 2
Diploma is desirable.
Good working condi-
tions and teamwork.
Telephone Manager:
01708 226362

**FRIENDLY? Caring?
Reliable?** Train for a
part time role as a Care
Worker in Havering.
Call 01708-731313

Cleaners

3 P/T Office Cleaners
Monday-Friday
Upminster 06.00-
08.00am
Rainham 17.00-18.45pm
Barking 06.30-08.15am
Call 01708 607508

CLEANERS required
Brentwood area,
hours 5am-8am
£6.50/h contact
01702 713100
Quote ref 322

Hotel, Catering & Bar Staff

CATERER for kiosk
Lakeside area.
Minimum 28hrs per
week. £7.25ph - £9.08.
Shift pattern will include
weekend work. Driver a
must. Telephone 01277
228536.

Drivers

Allied Recruitment
urgently require
HGV 1 DRIVERS
to work from Dagenham, North
London, Hatfield or Aylesbury.
Full/Part Time,
excellent rates paid.
Uniform provided. Driver CPC
courses can be provided
Contact Andrew or Dan on
020 8551 7422
07824 363 290

CLASS 1 Driver
required for trailer
movements between
Rainham + Dagenham.
Monday-Friday. Good
rates. Call 01375 843322

EXPERIENCED
7.5t & class 2 DRIVERS
REQUIRED.
**EXCELLENT RATES OF
PAY!!!!**
Contact Tony on
07554 747177

**ROMFORD based
Motor Bike Dispatch
Rider** with full car
licence for express deliv-
ery of motor parts
required.
Full time permanent
contract.
Apply via email to
joinus@motexgroup.com

PLEASE MENTION THIS
PAPER WHEN REPLYING TO
THESE ADVERTISEMENTS

Electricians

**TRAINEE Electrical
Engineer**
Permanent position
Monday - Friday 8am -
6pm. Microsoft Office
essential
Training given
Wage negotiable on
experience
Please call Cape
(Electrical &
Mechanical) Ltd
01708 733900

General Vacancies

**FABRICATORS
REQUIRED**
for Trainee &
experienced positions.
Aluminium bifold
door experience
would be beneficial
Contact
01708 707750

**PART-TIME MULTI-
SKILLED HANDYPER-
SON** wanted 1-2 days
per week upminster
area. Own tools & trans-
port £10 p/h. 020 8551
4808

RECYCLING and
packing staff urgently
required. Call us now!
01708 380390 (agy)

Hairdressing & Beauty

FANTASTIC opportu-
nities for **Stylists** and
Assist Managers to
progress their career
within our award win-
ning salon group.
Apprenticeships avail-
able for this year's
school leaver. 020 8551
4808. Uppercut Hair
Group

Office & Reception

**FULL-TIME
TELEPHONE
COLLECTOR**
Business 2 Business
Debt Collection Agency
requires applicant with
good communication skills,
assertive professional
telephone manner,
conscientious and
quick thinking.
**Call Gavin:
020 8551 4019**

**SAGE ACCOUNTS /
IT SKILLS / ADMIN** pre-
vious experience essen-
tial. Monthly end
accounts, Excel spread-
sheets, excellent tele-
phone manner. Previous
experience with a con-
struction company
would be an advantage.
2/3 days a week & holi-
day cover, salary nego-
tiable, Email C.V. and
covering letter to
accounts@nomicoelectrical.co.uk

Pre-School & Nurseries

EXPERIENCED Pre-
school Practitioner
required. Part-time,
term-time. Level 3.
Hornchurch. Telephone
07708 444473

LOCAL busy nursery
requires **Experienced
Cook** to work between
8.30 and 3.30. Must
have food & hygiene
level 2 certificate. Needs
to use own initiative
with menu providing
nutritious meals for chil-
dren. Call Lisa or Kay
on 0208 590 1413

**QUALIFIED
Nursery Nurse** required
for a very busy day nur-
sery in Brentwood.
Please e-mail CV to
info@clevertodaynursery.co.uk

Shops & Retail

**PART-TIME EXPERI-
ENCED FLORIST** must
be trustworthy, reliable.
Required for a busy
friendly shop 3 days a
week, must be willing to
work weekends and busy
times. Days vary weekly.
0208 551 7665.

Warehouse Staff

**STOREPERSON /
Driver**
Busy Industrial Fixing/
Fastener Company
Warehouse Work/ Trade
Counter Etc
Rainham
CV's to accounts@
xfasteners.co.uk

Get your CV in front of local employers

Upload it to **jobs24.co.uk** today
IN-PAPER • ONLINE • ON MOBILE

Legal and Public Notices

Goods Vehicle Operator's Licence

Function Business Services of 35 B Marsh Way, Rainham, Essex RM13 8UH is applying to change an existing licence as follows: To keep an extra 4 goods vehicles and 1 trailer at the operating centre at 35 B Marsh Way, Rainham, Essex RM13 8UH. Owners or occupiers of land (including buildings) near the operating centre(s) who believe that their use or enjoyment of that land would be affected, should make written representations to the Traffic Commissioner at Hillcrest House, 386 Harehills Lane, Leeds, LS9 6NF, stating their reasons, within 21 days of this notice. Representatives must at the same time send a copy of their representations to the applicant at the address given at the top of this notice. A Guide to Making Representations is available from the Traffic Commissioner's office.

NOTICE OF APPLICATION FOR A PREMISES LICENCE UNDER SECTION 17 OF THE LICENSING ACT 2003

APPLICANT: London Borough of Havering
PREMISES: Fairkytes Arts Centre, Billet Lane,
Hornchurch RM11 1AX

The proposed licensable activity is: sale of alcohol
and performance of recorded music

Full details of the application can be inspected at the
address noted below during normal business hours.

Any representations by an interested party or
responsible authority regarding this application can
be made to:

Licensing Team, Housing & Public Protection
London Borough of Havering
Mercury House, Mercury Gardens, Romford RM1 3RX
Website: www.havering.gov.uk

Such representation must be received in writing by:
20th October 2014, clearly stating the grounds upon
which the representation is made in relation to the four
objectives of the Licensing Act 2003.

It is an offence to knowingly or recklessly make a
false statement in connection with an application.
The maximum fine for which a person is liable on
summary conviction for the offence is £5,000.00.

Licensing Act 2003 Application to Vary Premises Licence

Name of Applicant: Malthurst Limited. Address:
Malthurst Faringdon, Faringdon Avenue, Romford,
RM3 0AB. Licensing Authority: Havering London
Borough Council. Licensing Authority Address: The
Licensing Team, Public Protection, London Borough
of Havering, c/o Town Hall, Main Road, Romford,
RM1 3BD, (where a record of the application may
be inspected during normal office hours). Licensing
Authority Website:

www.havering.gov.uk. The applicant has applied to
the Licensing Authority to vary the premises licence
for the above premises as follows: 1. To include late
night refreshment between the hours of 2300 and
0500 7 days a week. 2. To extend and make altera-
tions to the premises. Any person or responsible au-
thority (as defined by the Licensing Act 2003) may
make representations to the Licensing Authority no
later than 4 November 2014. Any representations
made to the Licensing Authority must be in writing.
It is an offence knowingly or recklessly to make a
false statement in connection with this application.
The maximum fine for which a person is liable on
summary conviction for this offence is £5,000.

Dated: 6 October 2014
Winckworth Sherwood LLP,
Minerva House, 5 Montague Close, London, SE1
9BB.
Ref: CVE/28715/67/RPB.
Solicitors and authorised agents for the applicant.

APPLICATION TO VARY A PREMISES LICENCE UNDER THE LICENSING ACT 2003

We, Hari News Limited, hereby give notice that we
have applied to the London Borough of Havering
Licensing Authority for the Variation of a Premises
Licence at: Bargain Booze, 3-5 Oak Road, Rom-
ford, Essex, RM3 0PH. The Variation is to: Lodge
plans of the revised internal sales display layout of
the premises only. Full details of the application can
be inspected at the address noted below during nor-
mal business hours. Any representations by an in-
terested party or responsible authority regarding this
application can be made to: The Licensing Team,
Housing and Public Protection, London Borough of
Havering, Mercury House, Mercury Gardens, Rom-
ford, RM1 3SL. Website: www.havering.gov.uk.

Such representation must be received in writing by
the 4th November 2014, clearly stating the grounds
upon which the representation is made in relation
to the four objectives of the Licensing Act 2003.
It is an offence knowingly or recklessly to make
false statements in connection with this application,
the maximum fine on summary conviction for the
offence is £5,000.

A great choice of cars
for sale in paper

Find over
200,000 cars
online at
drive24.co.uk

ARCHANT



Havering
LONDON BOROUGH

Map of the area



<p>Malthurst Faringdon</p>	<p>N ↑</p>
<p>nlpg The National Land & Property Gazetteer</p> <p>NSG NATIONAL STREET GAZETTEER</p> <p>Ordnance Survey Licensed Partner</p>	<p>Scale: 1:1000</p> <p>Date: 08 October 2014</p> <p>0 5 10 15 metres</p>
<p> Havering LONDON BOROUGH</p> <p>London Borough of Havering Town Hall, Main Road Romford, RM1 3BD Tel: 01708 434343</p>	<p>© Crown copyright and database rights 2014 Ordnance Survey 100024327</p>



Havering
LONDON BOROUGH

Representations from
Responsible Authorities

The Appropriate Officer
Licensing Authority
London Borough Of Havering
Town Hall
Main Road
Romford
Essex
RM1 3BD

**KD - Havering Borough
KD - Romford Police Station**

Romford Police Station
19 Main Road
Romford
RM1 3BJ
Telephone: 0208-218-9283
Facsimile:
Email:
lee.M.Davies@met.pnn.police.uk
www.met.police.uk
Your ref:
Our ref: Malthurst Farringdon Ltd
30 October 2014

Dear Sir

Licensing Act 2003
Malthurst Farringdon, Farringdon Avenue, Romford, Essex, RM3 0AB

Police are making representations to the above premises variation, the representation is based on one of the licensing objectives the prevention of public nuisance.

The premises is located on Farringdon Avenue, Harold Hill, and is boarded on two sides by a residential care home and further residential properties

Malthurst Faringdon is a 24 hour petrol station with convenience store. The application requested a late night refreshment licence, on reviewing the application, Section M contains the following statement **There are no proposed changes to the existing conditions of the premises licence.**

With this in mind the applicant has not sought to take additional measures to aid in the promotion of the licensing objective should a later licence be granted.

Having spoken to the applicants representatives I can confirm that the supply of late night refreshment will be administered through a serving hatch. This method will be adopted due to an existing condition on the licence, Condition 15 of annex 2 which states that the entrance door to the premises shall be closed to customers between 23:00 Hours and 05:00 Hours, The application has not sought to remove this condition. Furthermore during the conversation police were asked what conditions we would like to see, Police have advised that it is not our responsibility to make suggestions to the applicants representative, and that if the applicant is seeking a late night licence then they should advise us what they are going to do in order to minimise noise and anti-social behaviour.

The location of the premises is within walking distance of several local pubs, with the added attraction of a late night licence, late night revelers will see the premises as a place to buy hot food and drink, whilst on route home, as with many late night licences the immediate dispersal from the area will be delayed, as food is normally eaten within the environs of the place where it was purchased. This in turn will bring unwanted noise and anti-social behaviour to an area in which residents have come to expect minimal noise.

Police have been in consultation with the applicants representatives and despite advising them that further conditions should be included in the application, none have been forthcoming, therefore the police do not agree that the licence should be granted as we have concerns that the applicant is not willing to address the promotion of the licensing objectives in particular the prevention of public nuisance

If I can be of any further assistance please do not hesitate to contact me

Regards

Lee DAVIES
PC 403KD
Licensing office
Havering

Public Protection

Mercury House, Mercury Gardens
Romford RM1 3SL

memo

From: Marc Gasson-Noise Specialist

To: Paul Jones-Licensing Officer

Please call: Marc Gasson

Telephone: 01708 432777

Fax: 01708 432554

email: environmental.health@havering.gov.uk

Textphone ☎: 01708 433175

My Reference : MDG/016042

Your Reference :

Date: 22 October 2014

**Licensing Act 2003-Application To Vary Premises Licence
Malthurst Faringdon Faringdon Avenue Romford Essex RM3 0AB**

I refer to the application to vary a premises licence and advise as a responsible authority that I make representation against the application based upon my concerns in relation to the prevention of public nuisance.

The provision of late night refreshment between 23:00 and 05:00 has the potential to cause unacceptable levels of noise disturbance to nearby residents in Neave Crescent and Gascoyne Close whose rear gardens and bedrooms back onto and face towards the service station. In addition there is residential care home at the junction of Neave Crescent and Faringdon Avenue, bedrooms within which overlook the forecourt of the service station. Residents will be subject to noise from vehicle movements, raised voices and possibly music from the vehicles of patrons using the late night refreshment facility. The likelihood of noise disturbance noise is likely to be enhanced by the fact that this activity will occur only through a service hatch at the petrol station as indicated by the applicant thus leading to people congregating on the forecourt.

In addition and of concern to me is that the applicant has failed to provide any information as to how they intend to aid the promotion of any of the licensing objectives and in particular "the prevention of public nuisance".

I trust this clarifies my position

Marc Gasson
Noise Specialist

Public Protection

London Borough of Havering
Mercury House, Mercury Gardens
Romford RM1 3SL

Telephone: 01708 432692
Fax: 01708 432554
email: paul.jones@havering.gov.uk
Textphone ☎: 01708 433175

Date: 21st October 2014

The Appropriate Officer
Licensing Authority
London Borough of Havering
Town Hall
Main Road
Romford
RM1 3BD

My Reference: PJJ/016042

Dear Sir

Licensing Act 2003
Malthurst Faringdon Faringdon Avenue Romford RM3 0AB

With regard to *Malthurst Ltd's* application to vary a premises licence this licensing authority makes representation against the application based upon our concerns in relation to the prevention of public nuisance.

The extant premises licence numbered 11658 currently permits the supply of alcohol only. The application for this premises licence was made in May 2012. The original application also included a submission to be able to provide late night refreshment. This licensable activity was withdrawn by the applicant further to concerns expressed at that time by the licensing authority and the Police. The application to now include late night refreshment within the ambit of the licence has been submitted but the operating schedule appears not to have addressed any potential concerns the inclusion of this licensable activity might generate. Section M of the application contains the following statement in relation to the promotion of the licensing objectives:

There are no proposed changes to the existing conditions on the premises licence.

Effectively, then, the applicant does not intend to take any *additional* steps to aid the promotion of the licensing objectives, preferring instead to rely on existing conditions. These existing conditions might appear to be tailored to suit the off-sales of alcohol.

Malthurst Faringdon is a 24 hour petrol station with attendant convenience store. Condition 15 of annex 2 of the premises licence requires that *the entrance door to the shop shall be closed to customers between the hours of 23:00 and 05:00*. Contact with the applicant's representatives confirmed that this condition is to remain on the licence. It is our understanding that the premises currently serves all its customers between the hours of 23:00 and 05:00 through a small hatch.

Contd.

The application seeks to be able to provide late night refreshment both indoors *and* outdoors from 23:00 to 05:00. The application does not appear to clarify how or why the provision of hot food and/or drink to customers might take place *outdoors*. What seems clear is that any customer wishing to purchase hot food will be prevented from entering the premises by the aforementioned condition. Each customer will therefore be required to wait on the forecourt of the petrol station while the hot food is prepared. This might suggest the potential for noise nuisance should customers attend the premises on their way home from an evening out while under the influence of alcohol.

Contact with the applicant's representative also found that it is not currently the licence holder's intention to provide late night refreshment even if the application is granted. The *Subway* food outlet is to close at 23:00 each night as it does currently. The application, it was clarified, is to enable the licence holder to be able to provide hot drinks between 23:00 and 05:00. An alternative method of providing hot drinks to customers without the need for a premises licence authorisation would be to install a drinks vending machine at the premises. This would negate the need for late night refreshment to be added to the licence. Publicly accessible vending machines are exempt from the requirement to licence them for late night refreshment (*Schedule 2 para. 5(2)*).

While it may be the applicant's current intention not to provide late night refreshment the application, should it be granted as submitted, would permit late night refreshment to be provided at the premises, inside or outside, at any point in the future. Entirely absent from the licence, however, will be any attendant conditions to mitigate the potential for public nuisance that may be generated by the provision of hot food and/or drink throughout the early hours. We should also recognise, of course, that the area in which the premises lies is partly residential. The site is bordered on two of its four sides by residential housing. This includes an old people's home immediately adjacent to the convenience store. Further to this we might reasonably query why an authorisation for late night refreshment is sought at this stage when there is no intention to provide any hot food beyond hot drinks.

Premises which provide late night refreshment were included in the licensing regime for a reason as such premises provide a 'post-pub' destination. Rather than going home from an evening out late night revellers make their way to late night refreshment premises to have a bite to eat. Consequently the dispersal from the area is delayed as food is consumed in the vicinity of the shop in which it was bought. Attendant to this are public nuisance issues of noise and other forms of anti-social behaviour.

While this licensing authority is not opposed in principle to modifying the licence to permit the provision of late night refreshment we are concerned at the licence holder's apparent failure to address the promotion of the licensing objectives, particularly the prevention of public nuisance.

Yours faithfully

Paul Jones
Licensing Officer

Public Protection Bringing together Environmental Health & Trading Standards